

LOT 2, CERTIFIED SURVEY MAP NO. 3126, being a redivision of Lot 2, Certified Survey map No. 364, being a part of the Northwest $\frac{1}{4}$ of the Northwest $\frac{1}{4}$ of Section 10, Town 4 North, range 18 East, in the Town of East Troy, Walworth County, Wisconsin.

RECEIVED
OCT 10 1999

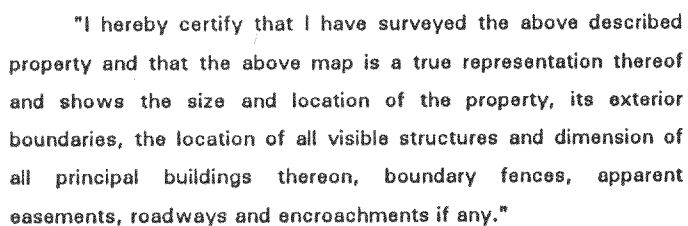

"This survey is made for the use of the present owners of the property, and also those who purchase, mortgage or guarantee the title thereto within one year from date hereof."

W356 S9050 Godfrey Lane
P.O. Box 357
Eagle WI. 53119

(414) 594-3484
fax (414) 594-5904

THIS IS NOT AN ORIGINAL SURVEY UNLESS THE SEAL IS RED.

9/14/99
DATE

TEP/DW
FIELD WORK BY

TEP
DRAWN BY

99217
JOB NUMBER

PA-3126-2

418-1329